

Philcon Dealer's Directory

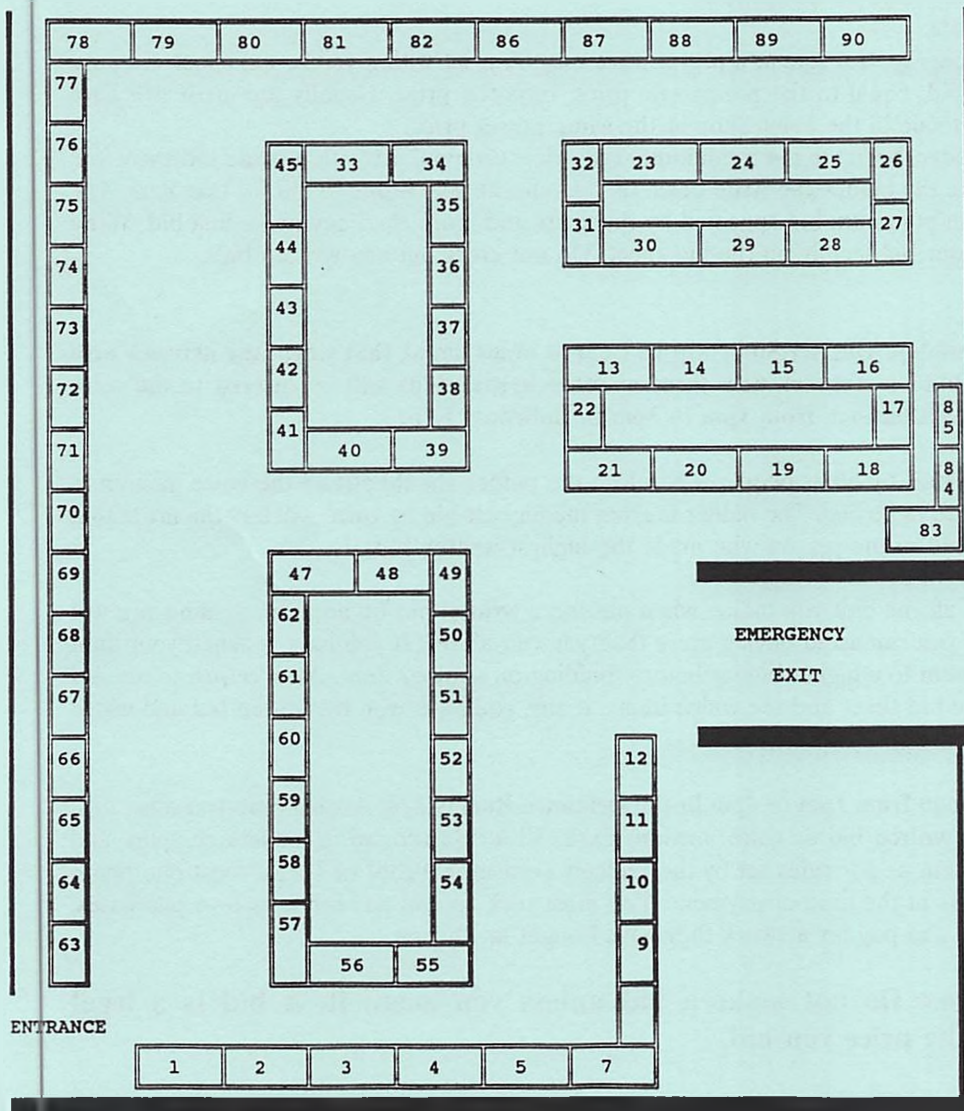

- 2 A.G.H.I.T.W Bookstore
- 37,38 Brian & Wendy Albright
- 21 Andrew Andrews
- 6 Angelcrafts
- 47,48 Annenberg Center for the Performing Arts
- 31,32 Arabian Nights Books
- 15,16 Austin Dridge
- 62 Avery Publishing Group, Inc.
- 55,56 John Gregory Betancourt
- 71,72 Black Dragon Pewter
- 22 Bizarrrt
- 57 British Books
- 19,20 Bump in the Night Books
- 88 Linda Bushyager
- 35,36 Chimera Publications
- 80,81 Collectables Express
- 89,90 Collector's Den
- 60,61 Comics and Things
- 13,14 The Dragon's Hoard
- 64,65 Dragon Treasures
- 74,75 J&J Books
- 58 John Emanuelli
- 34 Fantasy Beads
- 69,70 Fat Cat Books
- 23 Furtherance
- 59 Gene's Books
- 4,5 Guy's Glass Designs
- 63 Hardcore Hobbies
- 86,87 Graham Holroyd
- 40 Honek Sculptures
- 39 Juniper Forge
- 11,12 Keystone Comics
- 73 Janet Kofoed
- 53,54 Nancy Lebovitz Buttons
- 18 L5 Society of Philadelphia
- 33 Luna Publications
- 76,77 Robert A. Madle
- 78,79 Chuck Mayo
- 1 Philadelphia Science Fiction Society
- 9,10 The Reclining Dragon
- 25 RP&B Society's Guild
- 7,8 Sandscrafter
- 17 Darrell Schweitzer
- 28 Science Fiction Cronicle
- 24 Shadowwalker's
- 29,30 Showcase Comics
- 66-68 Space Station Studios
- 49-51 Dick Spellman Bookseller
- 83-85 Tales from the White Hart
- 52 Terra Incognitia
- 46 There is no table 46!
- 43 Tigereyes Books
- 3 Timeflies Books, Ltd.
- 26,27 Tower of Glass
- 41,42 Michael J. Walsh
- 82 Wail Songs
- 44,45 White Witch Miniatures

Art Show Rules

The Art Show is an exhibit of original SF, Fantasy and Fannish art in two-dimensional (e.g. sketches and paintings) and three-dimensional (e.g. sculpture) forms, executed by both professional and amateur artists. All artwork other than that marked "NFS" (i.e. "Not for Sale") is for sale by competitive (written and voice) bidding. There is also a Print Shop for direct sales of photoprints and lithographs, which is located along the common wall with the Dealer's exhibit area.

To bid on artwork you must:

- 1) Be a registered member of Philcon as evidenced by your Philcon badge.
- 2) Register at the Art Show Control Desk to receive your bidder number.

Each piece of artwork is tagged with an ID/bid sheet which lists the title of the piece, the medium and the name of the artist. The color of the bid sheet indicates the sale status of the artwork:

Blue: Artwork for display only, not for sale.

Yellow: Limited edition photoprint or lithograph for sale at a preset price only. A print with a yellow bid sheet will have a single line for a written bid. The first written bid, equal to the preset sale price, buys the print. Usually the artist will have submitted additional copies of the print for direct sale in the Print Shop at the same preset price.

White: Original art for sale to highest bidder, beginning at a minimum bid price. Original art with a white bid sheet will have several lines at the bottom of the sheet where the bidder can write down the amount he/she wants to bid for that item. The amount of the bid must be at least as much as the minimum bid specified by the artist and more than any preceding bid. Write your name, bidder number, and the amount of your bid legibly on the bid sheet. Do not cross out any written bids.

Written bidding will close at noon on Sunday. The Art Show will be cleared of all art at that time. Any artwork with less than three bids will be sold to the highest bidder. Artwork with three or more written bids will be entered in the voice auction. The voice auction will be held on Sunday afternoon from 1pm to 3pm in Ballroom E/F.

At the auction, the art is open to further bids by other people. Therefore the bidder should attend the voice auction to make further bids on pieces he/she is still interested in buying. The bidder making the highest bid by voice will buy the art at that price. If there are no voice bids, the art will be sold to the person who made the highest written bid.

Several words of warning: Keep track of all the bids you make; when placing a written bid on an item, assume you will be the winning bidder on ALL of them. This way you can avoid buying more than you can afford. If you have reached your limit of Art Show purchases, wait till you have lost an item to a higher bidder before bidding on another item. Also, return to the Art Show before it closes (Sunday, noon) to check the bid sheet and see which items, if any, you have won by written bid and which items will be going to voice auction.

Art Show Sales will be on Sunday afternoon from 1pm to 4pm in the Delaware Rooms 3/4. At this time you must pick up and pay for all items of art you have won by written bid or voice auction. Cash, Visa, Mastercard, travellers cheques, and personal check with ID will be accepted for payment as per rules set by the Philcon Treasurer. Proof of ID (at least one photo and proof of address) will be required of all buyers at the time of payment. You must pick up and pay for your own purchases. We **WILL** track down anyone who fails to collect and pay for artwork they have bought at Philcon.

Remember: you bid, you buy. Be Serious. Do not make a bid unless you mean it. A bid is a legal obligation to buy the art you bid on at the price you bid.

Weapons Policy

No weapons - guns, gun replicas, swords, Knives, lasers, model lasers, or anything that could be perceived as a weapon by the public - will be permitted at Philcon. The Philcon Committee has the final say as to what constitutes a weapon. Unfortunately, we must reserve the right to revoke the membership of anyone who refuses to comply with this policy.

The only exceptions to this policy are as follows: Registered participants in the Masquerade may wear a weapon, excepting guns and operational lasers, from one-half hour before to one-half hour after the Masquerade. Participants in the Costumers' Workshop may also wear weapons, with the same restrictions, while in the Workshop.